

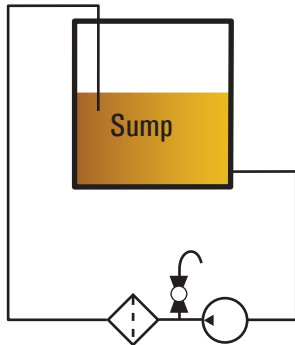

# Quick Oil Sampling Guide

The quality of analysis results depends on correct sampling and handling of the sample!



## How to take an oil sample - between the pump and the filter

To take an oil sample, the following is required:

- a 200 mL particle free glass bottle
- a cloth
- a 5 L (1 1/2 US gallon), open oil container
- label + pen

Pump must be in stable running condition before taking the oil sample



Note: Always take oil samples according to this guide in order to achieve valuable information about your equipment. If the oil sample is not taken properly, your money will be wasted!

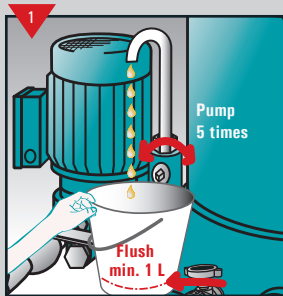

1. Place the oil container beneath the sampling valve.
2. Open and close the valve 5 times and leave it open.
3. Flush the pipe by draining 1 litre (1 US quart) into the container. Leave the oil running.

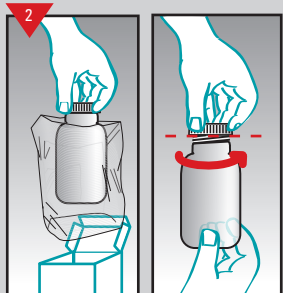

4. Open plastic bag and take out sampling bottle.
5. Unscrew lid completely, without removing the lid from the sampling bottle.

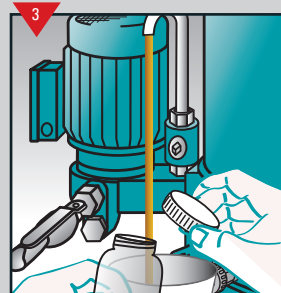

6. Hold the sampling bottle close to the oil flow and remove lid from the bottle.



7. Fill the sampling bottle to 80%, while holding the lid in one hand, without the bottle touching the sampling valve.

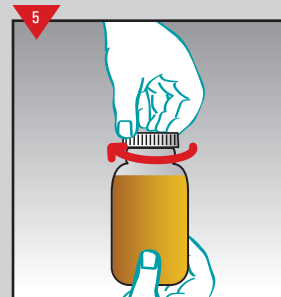

8. Screw on lid immediately, so that no unwanted particles can contaminate the oil sample.
9. Close oil sampling valve.

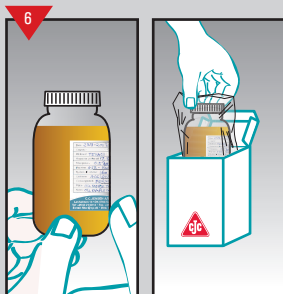

10. Fill in label and stick it onto the sampling bottle.
11. Pack the sampling bottle in plastic bag and cardboard container, and send via mail or courier.

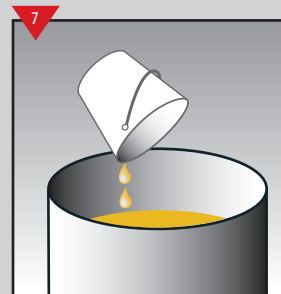

12. Dispose of flushing oil according to environmental requirements and rules and if necessary refill the oil in the system.

FL12006 - 10.02.2015



# Operating Vacuum Pump

The quality of analysis results depends on correct sampling and handling of the sample!

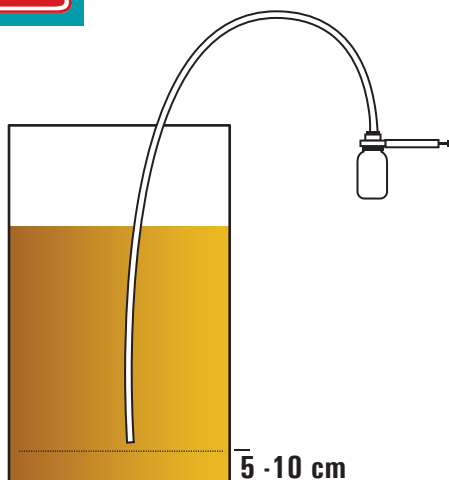

## How to take an oil sample - using a manual vacuum pump

To take an oil sample, the following is required:

- a 200 mL particle free glass bottle
- label + pen
- vacuum pump

A sample should be drawn from 5-10 cm above the lowest part of gearbox/tank.

Please read the following instructions carefully before taking the oil sample.

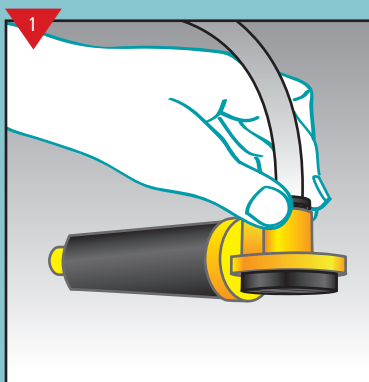

1 Cut a suitable piece of new flex tube off the roll.

Push one tube end into the pump head.

Lock by turning the lock-nut.

Always flush tube with 2 l. oil before taking the sample.

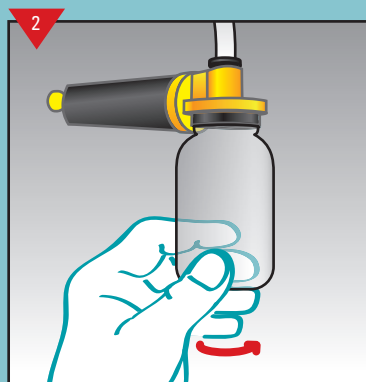

2 Fit the bottle by screwing it unto the pump head flange.

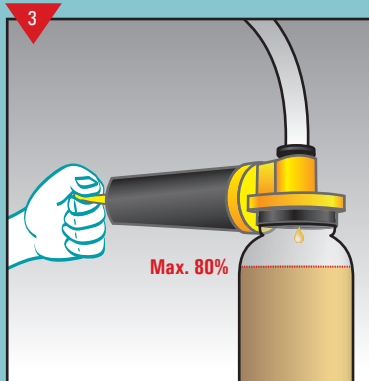

3 Create a vacuum in the bottle by a few pump strokes.

Fill 3/4 of the bottle. Loosen bottle on pump to stop oil flow.

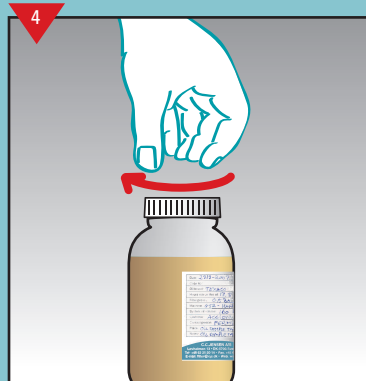

4 Close lid and label the bottle properly.

FL12007 - 10.08.2009